

## New Construction

### Polymer Rubber Gel Preformed Membrane

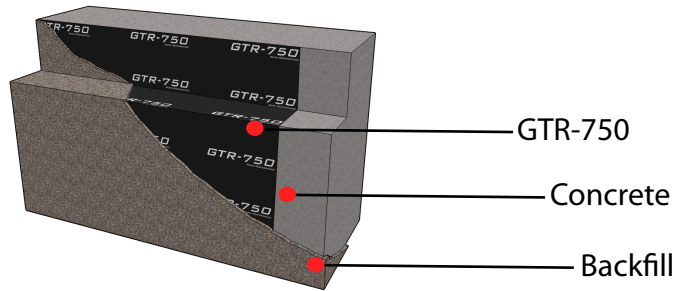

Preformed Sheet + Gel  
Positive Side Application

| Features                              |   | Benefits   |
|---------------------------------------|---|--|
| <b>Hybrid Composite Waterproofing</b> | Polymer rubber gel technology combined with a durable sheet for quick and easy application.   | Non-curing gel dynamically responds to substrate movement with integrated durable sheet for leak-free performance.                           |
| <b>Self-Healing</b>                   | GTR-750 is the world's only truly self healing sheet system. GTR-750 sheet has the unique ability to self heal under direct hydrostatic pressure.         | Eliminate concerns based on penetrations through the membrane for leak-free performance.   |
| <b>Self-Adhering</b>                  | GTR-750 bonds tightly to itself. Heat welding and seaming tape are unnecessary. GTR-750 is a true monolithic sheet membrane system.                       | Faster application with fewer opportunities for mistakes. Eliminate source for leaks.  |
| <b>Highly Adhesive</b>                | Adheres to various materials and substrates. Adhesive to metal, PVC, plywood, etc.  | Maintains a tight bond to the substrate and limits issues with detailing.  |
| <b>Durable</b>                        | Chemically resistant, resistant to salt water conditions. Resistant to freeze/thaw cycling and wet/dry cycling. Resistant to hydrocarbons. Non-flammable. | Waterproofing membrane is effective and long lasting in adverse conditions.  |
| <b>Flexible</b>                       | Polymer rubber gel never completely cures. Durable to movement, vibration, thermal expansion/contraction.   | Waterproofing membrane responds to movement maintaining the integrity of the waterproofing envelope. Excellent protection for seismic areas. |
| <b>Ease of Application</b>            | No primer or surface conditioner necessary for application. Can be applied in cold weather conditions. Factory controlled mil thickness.                  | Increased productivity speeds the construction schedule to completion.   |
| <b>Recycled Content</b>               | Manufactured from over 25% post-consumer recycled content.  | Contributes to project LEED qualifications. Environmentally responsible.   |
| <b>Warranty</b>                       | Up to 20 year warranty available, labor and material.   | Peace of mind. Long term effectiveness.  |